

CITY OF SANTA CLARITA SOLEDAD CANYON ROAD



NOTES:

1. SITE ADDRESS: SOLEDAD CANYON ROAD, CITY OF SANTA CLARITA, CA 91351
2. ASSESSORS PARCEL NUMBERS: 2805-024-001, 2805-025-029, 037, 063, 064, 066
3. THOMAS BROTHERS: 4551-2E
4. SITE AREA: 52.64
8. FLOOD ZONE: A, D

LEGEND:

- - - SITE BOUNDARY
- EXISTING PARCELS
- ▤ PROPOSED DRIVEWAY

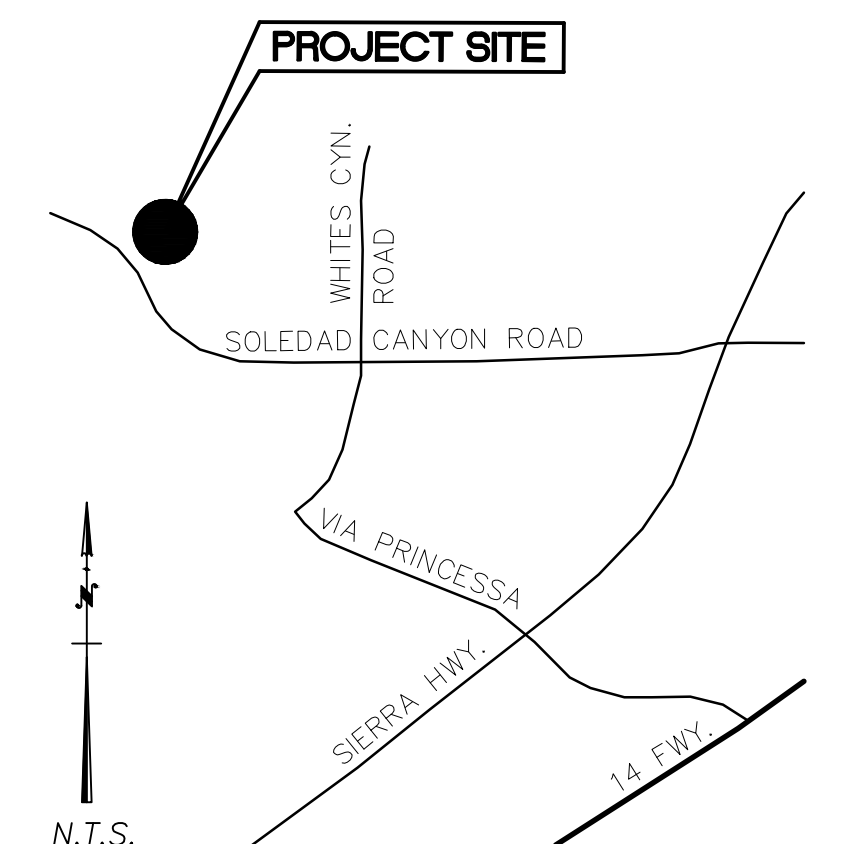

VICINITY MAP

THOMAS BROS. MAP: PAGE 4551-2E

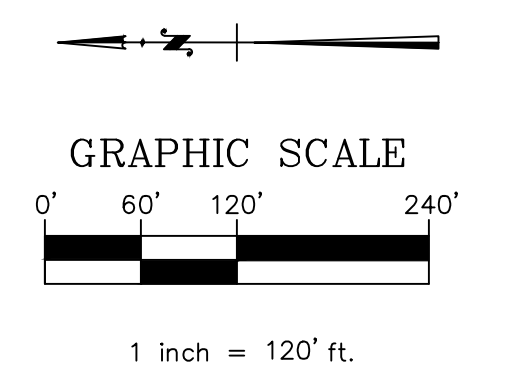

PROJECT SITE

M MORAN CONSULTING CORPORATION
 • CIVIL ENGINEERING • SURVEYING • LAND PLANNING
 4500 E. Pacific Coast Hwy
 Long Beach, California 90804
 (562) 340-4670 Fax (562) 340-4680
 E-Mail Address: cmoran@moran-corp.com

CESAR MORAN P.E. C72247 EXP. 6-30-18
 PROJ. MNGR. CESAR MORAN E-MAIL ADDRESS: cmoran@moran-corp.com
 DATE: 01/16/2017 JOB N°: 217003 DRAWN BY:

REVISIONS			
N°	DATE	BY	DESCRIPTION

PROPERTY OWNER:

PROJECT TITLE SOLEDAD CANYON ROAD SITE	
JOB ADDRESS SOLEDAD CANYON ROAD CITY OF SANTA CLARITA, CA 91351	SCALE: 1" = 120'
LEGAL DESCRIPTION	SHEET 1 OF 1

DRIVEWAY LOCATION EXHIBIT